

N 193000

N 192000

N 191000

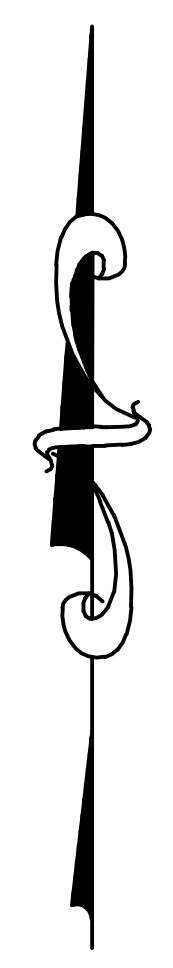

ATLANTIC OCEAN

BEACHFILL BERM AND DUNE TAPERED INTO EXISTING BEACH BERM AND DUNE. TAPER LENGTH = 1260'

APPROXIMATE SEAWARD LIMIT OF TAPER FILL, TO THE LIMIT IN TO EXISTING GRADE

APPROXIMATE SEAWARD LIMIT OF TAPER FILL

TAPER END: STA - (N12+60) (CONTRACTOR LIMIT OF WORK)

MEAN LOW WATER LINE AT TIME OF SURVEY ONLY FOR REFERENCE ONLY

TAPER END: STA S52+70 (CONTRACTOR LIMIT OF WORK)

APPROXIMATE SEAWARD LIMIT OF TAPER FILL, TO THE LIMIT IN TO EXISTING GRADE AT TAPER END

BEACHFILL BERM AND DUNE TAPERED INTO EXISTING BEACH BERM AND DUNE. TAPER LENGTH = 1540'

MATCHLINE SHEET 6

MATCHLINE SHEET 4

N-1+00
N-2+00
N-3+00
N-4+00
N-5+00
N-6+00
N-7+00
N-8+00
N-9+00
N-10+00
N-11+00
N-12+00

S52+00
S51+00
S50+00
S49+00

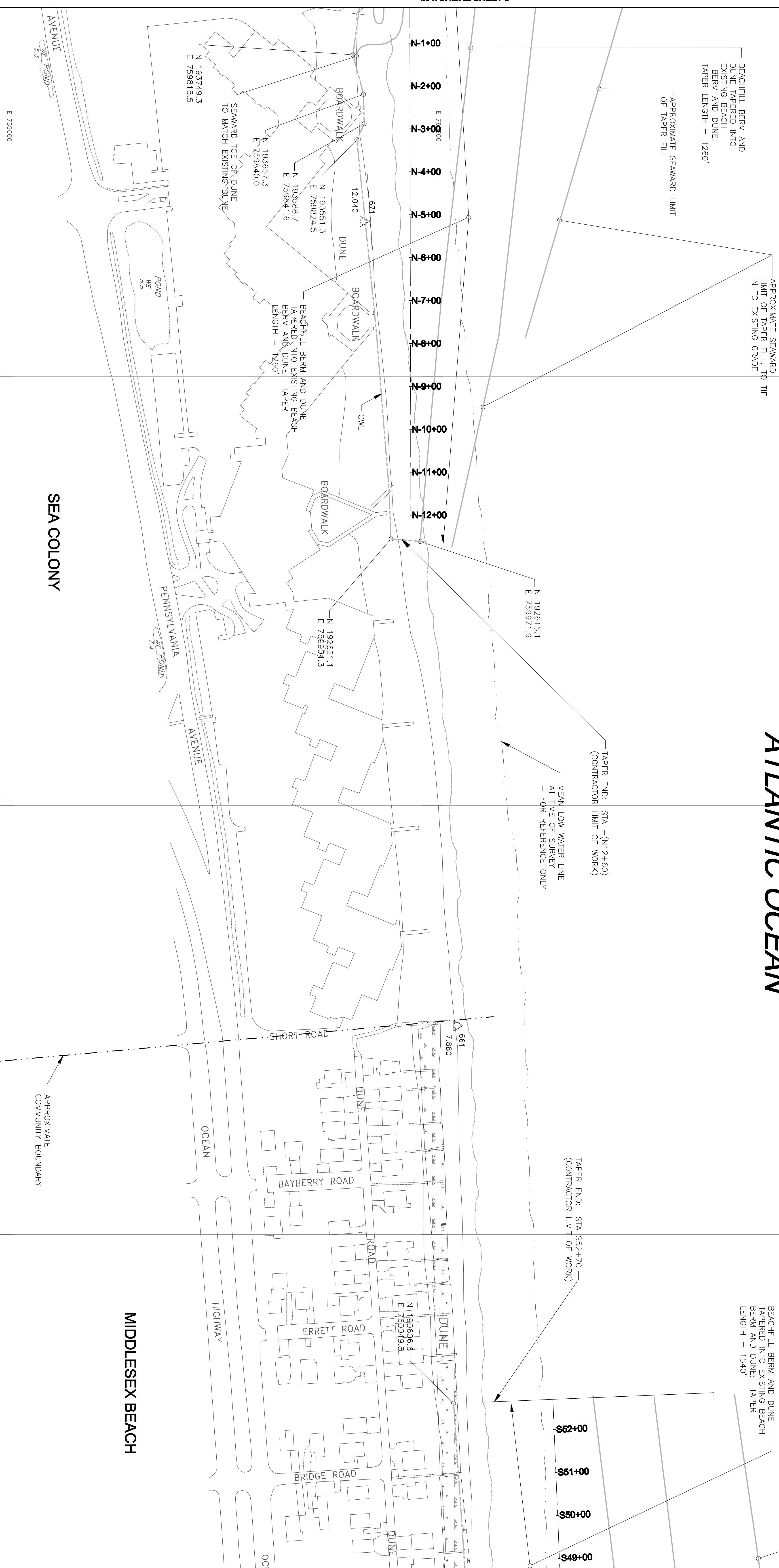

SEA COLONY

MIDDLESEX BEACH

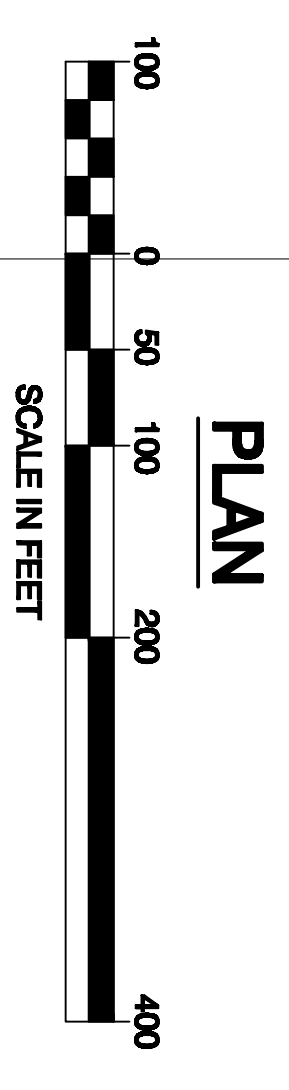

Sheet reference number: 63034
Sheet 5 of 20

BETHANY BEACH / SOUTH BETHANY
SUSSEX COUNTY, DELAWARE
BEACHFILL
PLAN - SEA COLONY AND MIDDLESEX BEACH

U.S. ARMY ENGINEER DIVISION
CORPS OF ENGINEERS
PHILADELPHIA, PENNSYLVANIA

Designed by:	TEH	Date:	DEC-1-2006	Rev.	1
Dwn by:	PGS	Cltd by:	GFM	Solicitation No.:	IFB W912BU-07-B-XXXX
Reviewed by:	GFM	Submitted by:		Drawing code:	
Chief, Design Branch		File name:	BERevisedREPlan.dwg	Plot date:	
		Plot scale:	AS SHOWN		

Mark	Description	Date	Appr.	Mark	Description	Date	Appr.

US Army Corps of Engineers Philadelphia District